



# INSTRUCTION BULLETIN

No. 9005110  
Machine: See Synopsis  
Published: 07-2015  
Rev. 02

**NOTE: DO NOT DISCARD the Parts List from the Instruction Bulletin. Place the Parts List in the appropriate place in the machine manual for future reference. Retaining the Parts List will make it easier to reorder individual parts and will save the cost of ordering an entire kit.**

*NOTE: Numbers in parenthesis ( ) are reference numbers for parts listed in Bill of Materials.*

Installation instructions for **kit number 9005081 / 9005082**

## SYNOPSIS:

This kit contains the parts needed to replace the seat on 6100, 6200, 6400, 7100, 7300, S30, T7, T15, EZ Rider, and R14 machines.

Please follow step-by-step instructions.

## SPECIAL TOOLS / CONSIDERATIONS: NONE

(Estimated time to complete: 45 minutes)

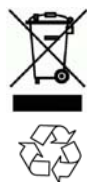

### PROTECT THE ENVIRONMENT

Please dispose of packaging materials, used machine components such as batteries and fluids in an environmentally safe way according to local waste disposal regulations.

Always remember to recycle.

## PREPARATION:

1. Park the machine on a clean level surface, lower the scrub head, turn off the machine, remove the key, and set the parking brake.

**FOR SAFETY: Before leaving or servicing machine, stop on level surface, turn off machine, and remove key.**

2. Disconnect the battery cables from the batteries.



**WARNING: Always disconnect battery cables from machine before working on electrical components.**

## INSTALLATION:

*NOTE: Refer to Fig. 2 to install kit 9005082 onto 6100, 6200, 7100, 7300, S30, T7, T15, EZ Rider, and R14 machines. Refer to Fig. 3 to install kit 9005081 onto 6400 machines.*

1. Disconnect the wire harness from the seat switch.
2. Remove the seat switch and all components that must be removed in order to remove the seat from the machine. Set all removed components aside.
3. Remove the old seat from the machine. Discard the seat and any other items being replaced. Set remaining hardware and components aside. These items are needed to install the new seat (1) onto the machine.
4. **Machines equipped with seat switch 223078 only:** Remove the cap and base from the seat switch. Discard the cap and base. (Fig. 1)
5. Install the seat switch into the new seat (1). (Fig. 2 / Fig. 3)
6. Set the new seat (1) onto the machine and connect the wire harness to the seat switch.
7. **6100, 6200, 7100, 7300, S30, T7, T15, EZ Rider, and R14 machines only:** Use four pan screws (2), four spacers (3), and set aside hardware and components to install the seat (1) onto the machine. (Fig. 2)
8. **6400 machines only:** Use the two seat brackets (2) and set aside hardware and components to install the seat (1) onto the machine. (Fig. 3)
9. Reinstall any components removed in Step 1 back onto the machine.
10. Reconnect the battery cables to the batteries.
11. Test the machine. Press the propel pedal without an operator sitting in the seat. The machine should not move.

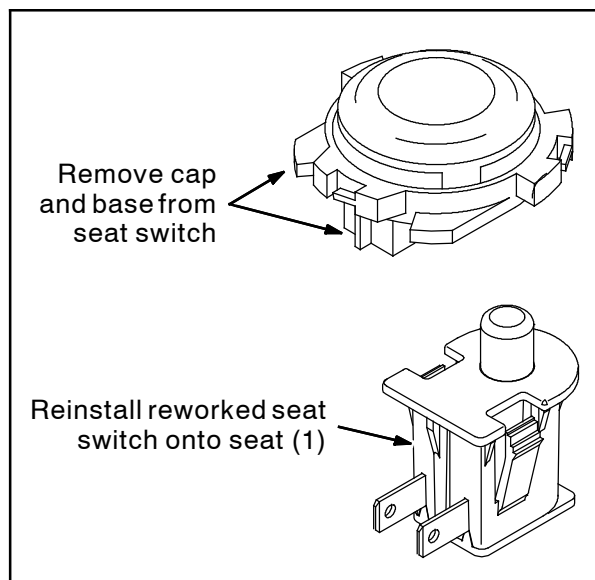

**FIG. 1**

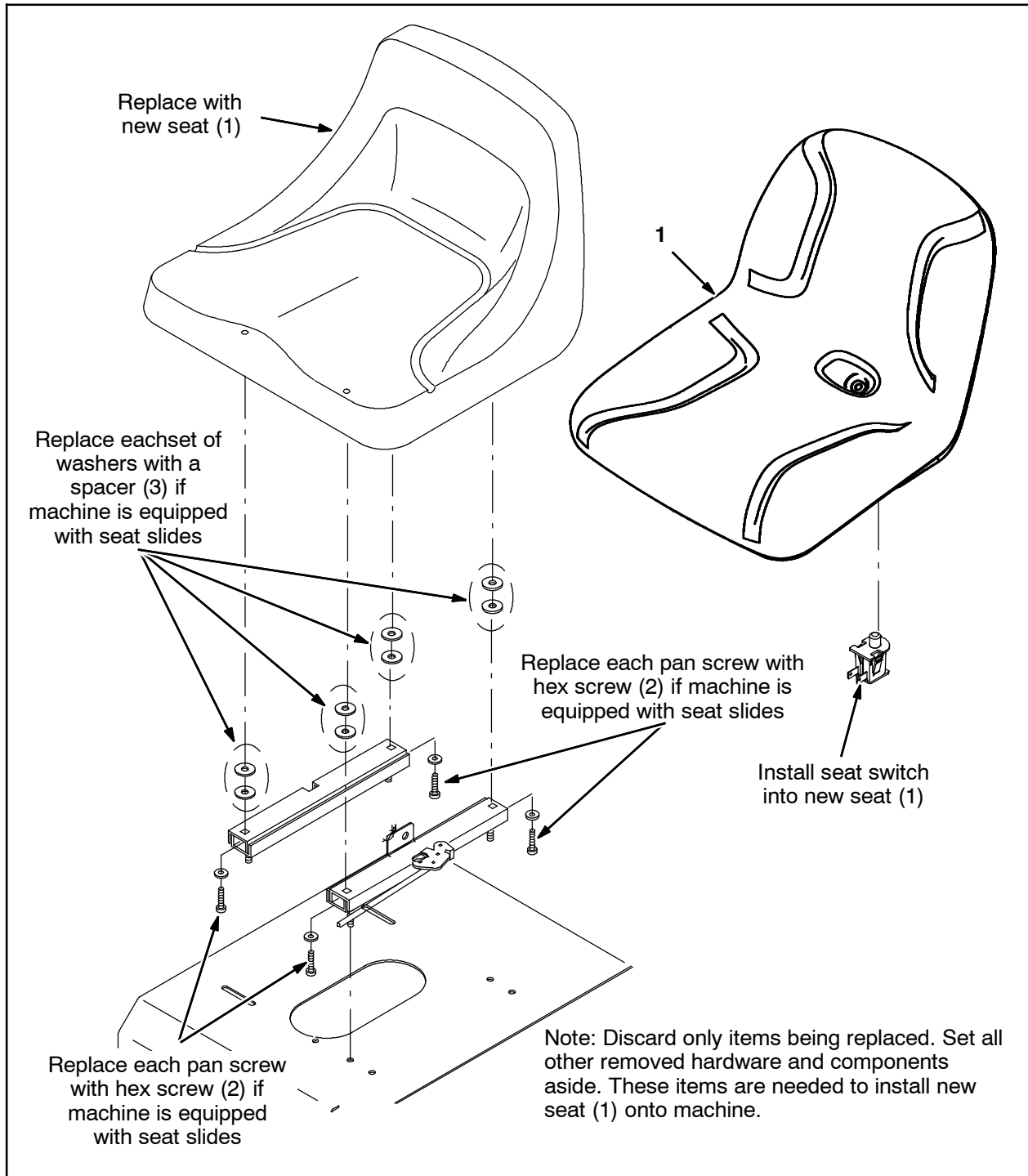

**FIG. 2 - 6100, 6200, 7100, 7300, S30, T7, T15, EZ Rider, and R14 machines**

**Bill of Materials for Seat Kit, Std, Replmt - 9005082**

Ref.	Tennant Part No.	Description	Qty.
▽	9005082	Seat Kit, Std, Replmt	1
▲	1 1201894	Seat, Std [Milsco]	1
▲	2 76956	Screw, Hex, .31- 18 X 1.25, G5	4
▲	3 1049092	Spacer, Rnd, .38B .88D .63L	4

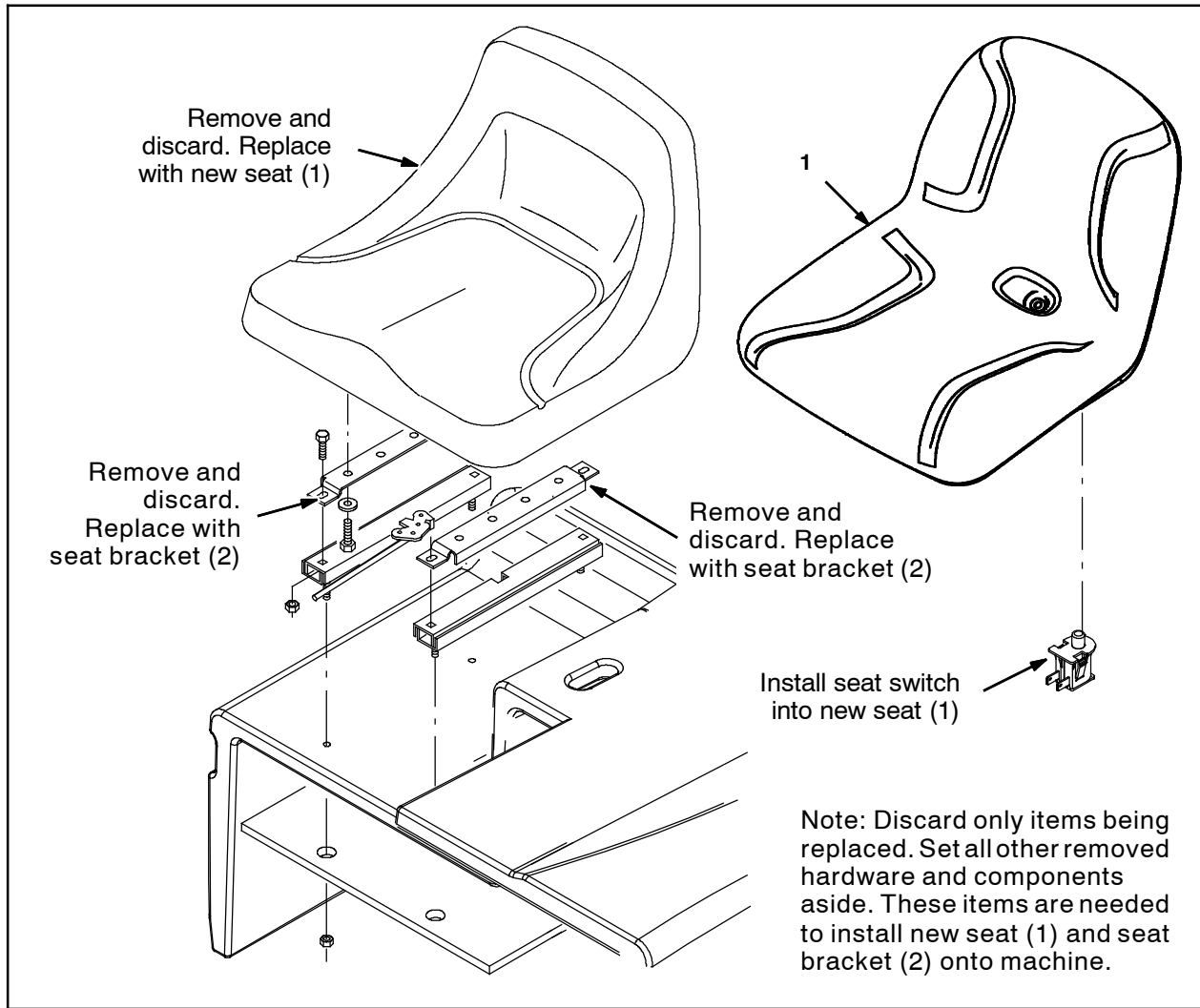

**FIG. 3 - 6400 machines only**

**Bill of Materials for Seat Kit, Std, Replmt [6400] - 9005081**

Ref.	Tennant Part No.	Description	Qty.
▽	9005081	Seat Kit, Std, Replmt [6400]	1
▲ 1	1201894	Seat, Std [Milsco]	1
▲ 2	1045229	Bracket, Adj, Seat	2

TENNANT COMPANY  
P. O. Box 1452  
Minneapolis, MN 55440-1452